

# SERIES 500 & 600 STANDARD KEYWAY BROACH CHART

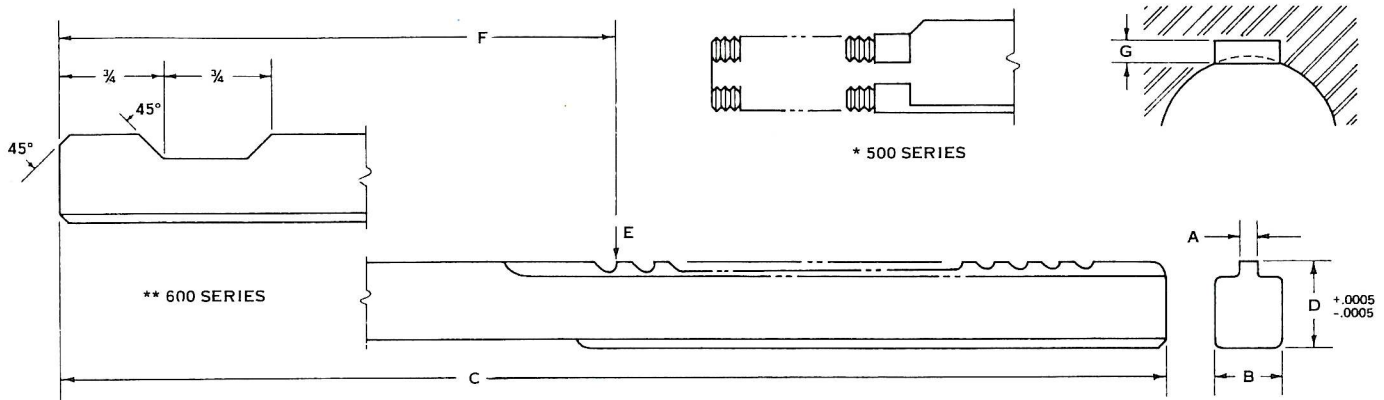

*	**	A		MIN. HOLE SIZE	MIN. LENGTH CUT	MAX. LENGTH CUT	B	C	D	E	F	G	NO. OF CUTS	THREAD SIZE
		NOM. DIM.	Decimal DIM.											
501	601	1/16	.0635	±.0002	3/8	1/4	.1552	20	.313	.271	7 13/16	.042	1	1/4-20
502	602	3/32	.0948	±.0002	7/16	1/2	.1865	24	.367	.309	8 1/4	.058	1	5/16-18
503	603	3/32	.0948	±.0002	5/8	2 1/2	.249	33	.491	.433	10	.058	1	3/8-16
504	604	1/8	.126	±.0002	1/2	1 1/2	.249	30	.438	.364	9	.074	1	3/8-16
505	605	1/8	.126	±.0002	7/8	2 1/2	.3115	36	.594	.520	10	.074	1	1/2-13
506	606	5/32	.1572	±.0002	1 9/32	1 1/2	.249	30	.525	.436	9	.089	1	3/8-16
507	607	5/32	.1572	±.0002	2 3/32	5/8	.3115	33	.625	.536	10	.089	1	1/2-13
508	608	3/16	.1885	±.0002	1 1/16	5/8	.374	36	.581	.476	10	.105	1	1/2-13
509	609	3/16	.1885	±.0002	1 5/16	1 1/16	.374	36	.796	.691	10 1 1/16	.105	1	1/2-13
510	610	7/32	.2198	±.0002	1 1/16	5/8	.374	33	.557	.437	10	.120	1	1/2-13
511	611	7/32	.2198	±.0002	1 5/16	1 1/16	.374	42	.813	.693	11 1/16	.120	1	1/2-13
512	612	1/4	.251	±.0002	1 1/16	5/8	.374	36	.612	.476	10	.136	1	1/2-13
513	613	1/4	.251	±.0002	1	1 1/16	.499	45	.877	.741	11 1 3/16	.136	1	5/8-11
514	614	1/4	.251	±.0002	1 7/16	7/8	.624	51	1.250	1.114	13 1/2	.136	1	3/4-10
515	615	3/32	.2828	±.0002	7/8	1 1/16	.499	42	.716	.564	11 5/8	.152	1	5/8-11
516	616	3/32	.2828	±.0002	1 1/4	7/8	.499	51	1.093	.941	13 1/2	.152	1	5/8-11
517	617	5/16	.314	±.0002	1	1 1/16	.499	45	.908	.741	11 1 3/16	.167	1	5/8-11
518	618	5/16	.314	±.0002	1 5/16	7/8	.499	51	1.158	.991	13 1/2	.167	1	5/8-11
519	619	3/8	.3765	±.0002	1 1/16	1 1/16	.499	45	.938	.739	11 1 3/16	.199	1	5/8-11
520	620	3/8	.3765	±.0002	1 5/16	7/8	.499	54	1.189	.990	13 1/2	.199	1	5/8-11
521	621	7/16	.439	±.0002	1 1/16	1 1/16	.624	48	1.390	1.160	12	.230	1	3/4-10
522	622	7/16	.439	±.0002	2	1	.624	48	1.611	1.496	15 5/8	.230	2	3/4-10
523	623	1/2	.5015	±.0002	1 1/2	1 1/16	.624	48	1.312	1.051	12	.261	1	3/4-10
524	624	1/2	.5015	±.0002	1 1/2	1	.624	48	1.377	1.246	16 1/2	.261	2	3/4-10
525	625	9/16	.5645	±.0003	1 3/4	1 1/16	.6865	54	1.438	1.146	11 1 3/16	.292	1	1 - 8
526	626	9/16	.5645	±.0003	1 5/8	1	.6865	51	1.391	1.245	16	.292	2	1 - 8
527	627	9/16	.5645	±.0003	2 1/4	1 1/8	.874	60	1.641	1.495	20	.292	2	1 - 8
528	628	5/8	.627	±.0003	1 7/8	1 1/16	.749	60	1.625	1.301	12 3/16	.324	1	1 - 8
529	629	5/8	.627	±.0003	2 1/2	1	.874	54	1.657	1.495	16 3/8	.324	2	1 - 8
530	630	5/8	.627	±.0003	2 1/4	1 1/8	.874	57	1.657	1.495	20	.324	2	1 - 8
531	631	3/4	.752	±.0003	1 7/8	1 1/16	.874	60	1.625	1.239	12 3/16	.386	1	1 - 8
532	632	3/4	.752	±.0003	2	1	.999	60	1.688	1.495	16 1/4	.386	2	1 1/4 - 7
533	633	3/4	.752	±.0003	2 1/4	1 1/8	.999	57	1.688	1.560	20	.386	3	1 1/4 - 7
534	634	7/8	.877	±.0003	2 1/4	1 1/16	1.124	63	1.875	1.426	12 3/8	.449	1	1 1/4 - 7
535	635	7/8	.877	±.0003	2 1/4	1	1.124	63	1.719	1.494	15 3/4	.449	2	1 1/4 - 7
536	636	7/8	.877	±.0003	2 1/4	1 1/8	1.124	63	1.719	1.569	20	.449	3	1 1/4 - 7
537	637	1	1.002	±.0003	2 1/4	5/8	1.249	63	1.750	1.239	10 1/2	.511	1	1 1/2 - 6
538	638	1	1.002	±.0003	2 1/4	7/8	1.249	63	1.750	1.494	14 1/4	.511	2	1 1/2 - 6
539	639	1	1.002	±.0003	2 1/4	1 1/8	1.249	60	1.750	1.580	20	.511	3	1 1/2 - 6



Order broaches by numbers found in first column. If this list does not include a cutter that meets your requirements, simply order keyway broach, stating size of keyway and hole, material to be broached and length of part. Standard and special blanks normally stocked in all sizes.

POST OFFICE BOX 2277, KINGSFORD, MICHIGAN 49802 • 906/774-4917 • FAX 906/774-6981